



**SMART**  
FURNITURE IDEA BOOK





\* Refer Website

#### Warranty

For Warranty  
please refer to website.  
[www.hettich.com/in](http://www.hettich.com/in)



#### Free Design Service:

Looking for Designs to liven up your Living Room, Bedroom, Bathroom & Kitchen. A dedicated team of highly qualified Interior Designers is at your service to provide customised design solution to suit every taste and budget at zero cost to you.

#### Free Consultation at your doorstep:

Looking for perfect Furniture Fittings solution? A dedicated team of highly qualified professionals is at your service to provide the perfect furniture fittings solution to suit your need and budget at zero cost to you.

#### Hettich Customer Care Service:

In today's fast paced and technologically advanced era, most of the organizations succumb to the pressure of staying ahead in the competition and often, end up neglecting the most critical aspect of business i.e. CUSTOMERS. Hettich, being a CUSTOMER CENTRIC organization, is very sensitive towards this tendency; hence, we constantly try to provide the best and quality driven products and services.

#### Enquiry & Customer Services

Toll Free : 1800 209 2096 (office hours)  
Email: [sales\\_enquiry@in.hettich.com](mailto:sales_enquiry@in.hettich.com)  
[customer\\_services@in.hettich.com](mailto:customer_services@in.hettich.com)  
[www.hettich.com](http://www.hettich.com)

#### Free Training Services:

Free Training Services for carpenters of trade partners and customers

#### Training Centre:

Hettich Poddar Wood Work Institute  
Plot No.2, First Floor,  
DLF Industrial Estate - 1  
Near NHPC Metro Station  
Faridabad, Haryana

Email: [info@hpwwi.com](mailto:info@hpwwi.com)  
Ph: 0129 - 4203888



**Hettich Poddar  
WoodWorking  
Institute**  
Skiiling • Upskiiling • Reskiiling

# AF SMART FURNITURE IDEA BOOK



# ABOUT US

The company's origins date back to 1888, when Karl Hettich began making the new clock component he had invented. By 1930, his descendants had diversified into furniture fittings, setting up production in East Westphalia – a Centre of the German furniture industry.

Today, Hettich, still family owned, has become an industry leader with a worldwide reputation. We're one of the world's largest manufacturers of high quality furniture fittings, with over 6,000 employees in more than 100 countries. The company's success has been built on four enduring values: quality, innovation, close cooperation with customers and absolute reliability. We work to inspire our customers with our ideas and our passion.



📍 Hettich Manufacturing Plant at Kirchlegern, Germany



📍 Hettich Manufacturing Plant at Vadodra, India



📍 Hettich Manufacturing Plant at Indore, India

# KEY HIGHLIGHTS

## Smart Furniture The Next Trend!

Technology has definitely changed over the decade through wireless innovations and artificial intelligence. These days we are looking for quick solutions to solve our problems and ways to simplify our lives just by saying "Alexa! What is the temperature outside?" Modern day furniture is far more advanced and is capable of doing lot many things that we look forward to because of its technology, sustainability, multi-functionality and efficiency.

Users will surely prefer having such revolutionary furnitures in their homes just because of how convenient they are primarily due to the convenience that it offers. With the right blend of Hettich's Innovative Furniture Fittings and the technological integrations, users will be able to interact with both; design and function.

It is amazing to see how emerging technology is shaping the furniture industry and this "Smart Furniture Idea Book" has been conceptualized to address the needs of modern day living.



### TREND SETTER

- Technology
- Soft lines
- Metallic Surfaces
- Post Pandemic Needs

One of the major areas around which trend revolves is technology and soft metallic lines and forms.

A subtle balance of ease, with a high engagement of function is what one seeks.



### UPGRADES LIFESTYLE

- Nature
- Health
- Up-Beat
- On Track

A healthy way of life is being amidst bounty of nature.

This keeps you up-beat and on-track.



### ENHANCES EFFICIENCY

- Work Environment
- Interior Factors
- Rapport Building
- Surroundings

Be mindful, and adapt yourself with qualities which makes work easy and fun.

A different thinking perspective in action!



### HIGHLY VERSATILE

- Multi-purpose
- Empathetic Design
- User-centric
- Adaptive

Embrace and adapt are the key skills of the upcoming alpha generation.

They make way with highly empathetic and user-centric design solutions which define versatility.



IDEA #1

VEIL

Bathroom | Vanity

Veil makes your space look clean and tidy. The sink housed in a sleek metal body, subtly gathers all the storage elements making it accessible.

★  
Technology Integrated: Foldable Sink  
A revolutionary idea which keeps everything intact & integrated with a faucet and a drain pipe allowing creative flexibility.

**FITTINGS**

- ① SlideLine M Sliding System
- ② Quadro Runner
- ③ Sensys Hinge

**CMF**

Snow White, Hickory  
Stainless steel, Mirror, HDHMR  
Matt and Silky Blasted

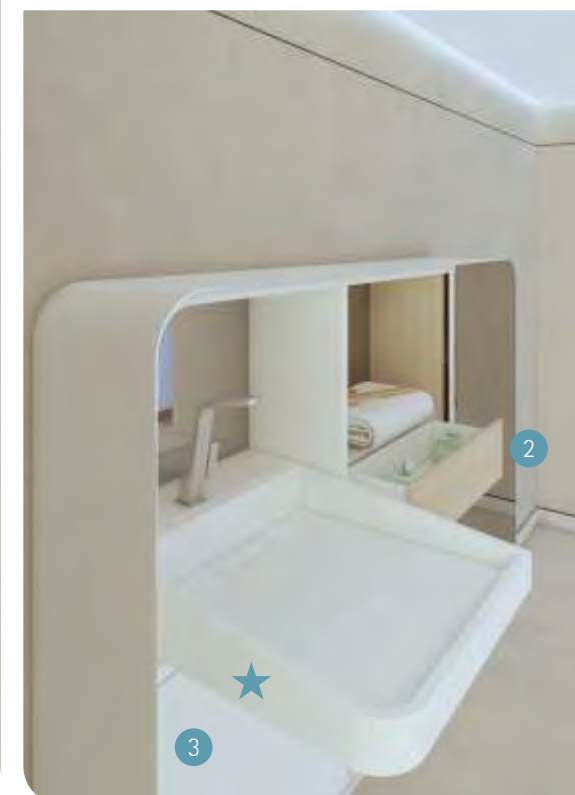

#camouflage #bathroominterior #hettichfurniturefitting

IDEA #2

PIXEL

Dining Room | Crockery Unit

Created with a grid topology, which houses your crockery in a simple fashion. It has an inbuilt warming tray, which lets you heat your food on the go. Additionally, having a voice assistant device complements your space and furniture.

★  
Technology Integrated: Warming Tray  
Keep food warm and ready to serve. Place a heat-resistant cookware on top and entertain your guests without any wait!

**FITTINGS**

- ① SlideLine M Sliding System
- ② Cube PLUS Shelving System
- ③ EcoSpot Magic Light

**CMF**

Beige, Misty Grey  
HDHMR  
Super Matt

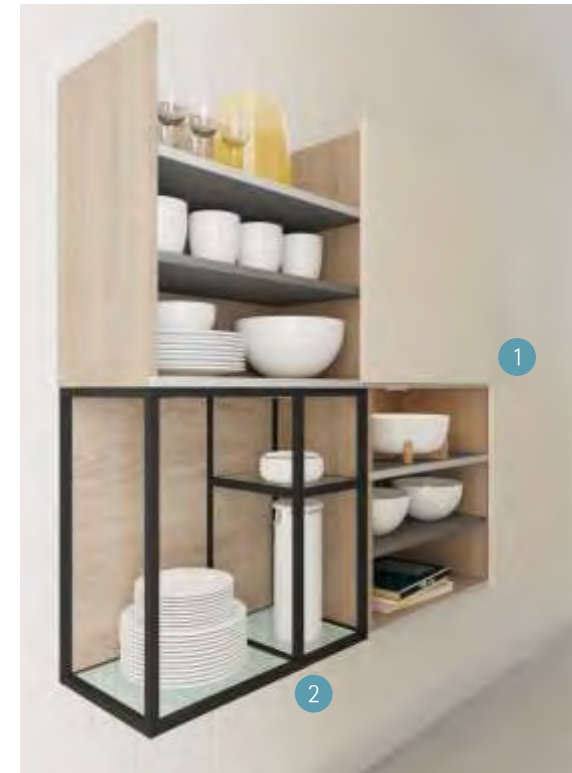

#handy #diningroominterior #hettichfurniturefitting





IDEA #3

# SIGMA

Bedroom | Study Unit

Sigma makes your work life easy and balancing. No more hassles with power sources, courtesy the sleek and modular power socket. House many devices at one place without any discomfort.

★  
**Technology Integrated: Slide-On Socket**  
The portable sliding socket lets you charge your devices with flexible options. Each module can be removed and added as per your requirement.

#### FITTINGS

- 1 SlideLine M Sliding System
- 2 AvanTech YOU Drawer System
- 3 Obsidian Hinge

#### CMF

Snow White, Beige, Alder, Misty Grey  
MDF, MS Sheet  
Super Matt



#slide #bedroominterior #hettichfurniturefitting



IDEA #4

# ARMIS

Terrace | Outdoor Unit

Let Armis, the neo contemporary piece, offer its multi-utilitarian functions with joy. The sleek thin body metal structure which houses the compact gym, makes your time at the terrace more fruitful over looking a breezy and a sunny morning.

★  
**Technology Integrated: Compact Gym**  
Feeling lethargic? Dont worry, just pull up this bench which rests under your seat, and get going and burn some calories! The compact product, collapses and slides down to your cabinet. Exercise made easy & convenient.

## FITTINGS

- ① Vertico Mono Vertically Sliding System
- ② Quadro Runner
- ③ SlideLine M Sliding System

## CMF

Silver, Peach, Hemlock  
HDHMR, MS Sheet, Felt Fabric  
Satin, Brushed Metal



#rejuvenate #terracedecor #hettichfurniturefitting





IDEA #5

# TETRIS

Hallway | Shoe Cabinet

Tetris allows maximum functionality with ease and efficiency. It lets you store your most prized possessions like your footwear. The long mirror lets you keep a check on your outfit every time you walk out of your house.

★  
**Technology Integrated: Rolling Shoe Cabinet**  
A fully automated shoe rack that not only lets you store plenty of pairs but also offers the ease to select it. It comes with a motorised area, which rotates on your command.

## FITTINGS

- ① Sensys Hinge
- ② Actro 5D Runner
- ③ LuckyLite Pro Magic Light

## CMF

Beige, Misty Grey  
MDF, Acrylic Sheet, Mirror  
Super Matt



#ease #hallwayinterior #hettichfurniturefitting



# DRAWER SYSTEMS & HINGES



## AvanTech YOU

- Creative flexibility in slim and high-quality design
- Hidden working parts, perfect performance
- Colours: silver, anthracite and white



## ArciTech

- Excellent running action, perfect Silent System performance
- 40, 60 and 70 kg loading capacities
- Support bigger shutter front upto 1200 mm width



## InnoTech Atira

- Distinctive, sleek design
- Platform concept for different design options
- Quadro drawer runner with a loading capacity of up to 50 kg



## Sensys

- Concealed hinge with clip on installation with integrated Silent System
- Quality classification under EN 15570, Level 3
- For door thickness 10 - 32 mm

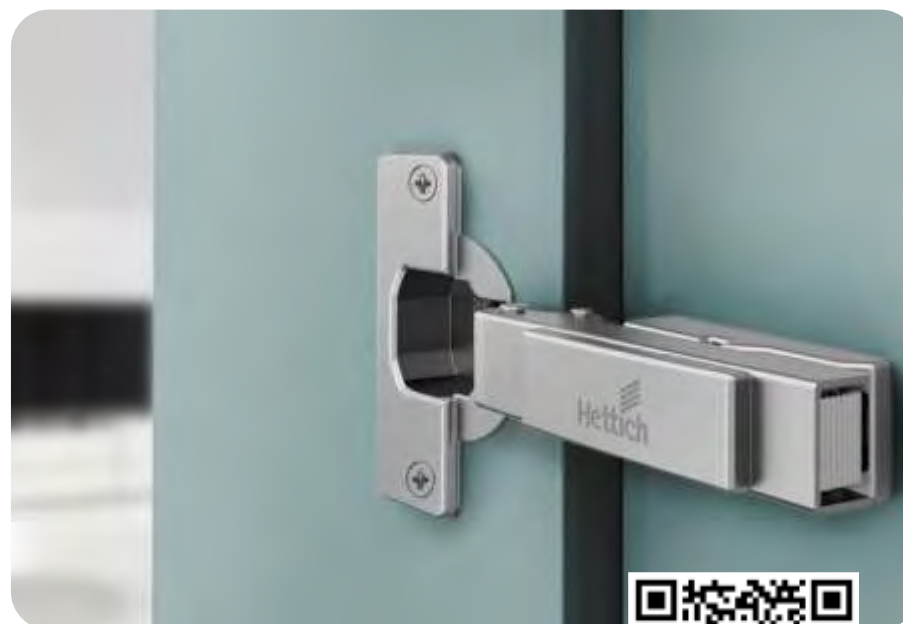

## Intermat

- Concealed hinge with clip on assembly
- Quality classification under EN 15570, Level 3
- For door thickness 14 - 43 mm



## Onsys

- Concealed hinge with clip on installation with integrated Silent System
- Quality classification under EN 15570, Level 2
- For door thickness 14 - 25 mm





IDEA #6

# VIRTUA

Home Office | Podcast station

Virtua - the next - gen podcasting station, helps you in and out. It balances out every detail with a touch and a gesture control sensor embedded in its core. Be the next sensation in the podcasting industry!

★  
Technology Integrated: Embedded Screen  
Interactive and adaptable screen modules. Wirelessly paired to your devices, where you can stream a podcast and having multiple windows for your activities.

## FITTINGS

- 1 WingLine L Sliding Folding System
- 2 Cube PLUS Shelving System
- 3 Quadro Runner

## CMF

Beige, Misty Grey  
MDF, Acrylic Sheet, Mirror  
Super Matt

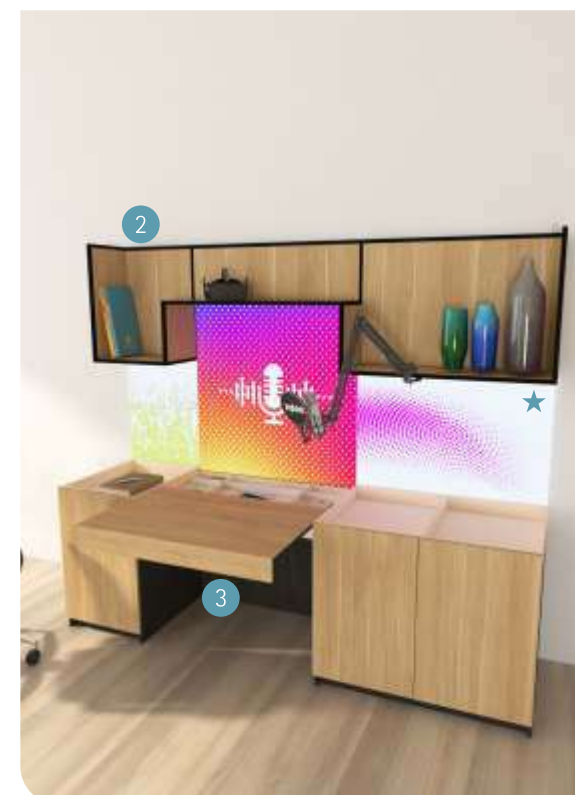
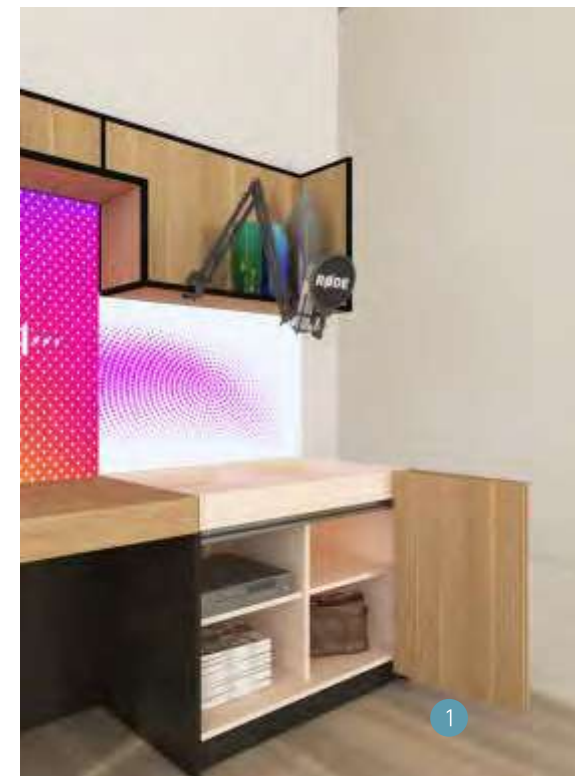

xcite #homeofficeinterior #hettichfurniturefitting



IDEA #7

# LUKE

Living Room | Showcase

This all - rounder helps you keep your belongings just the way you prefer. It gives importance to every artefact in there and also lets your most personal possession be hidden from the everyday crowd.

★  
**Technology Integrated: Personalised Locker**  
No longer waste time searching for your misplaced wallet, keys, jewellery etc. or exposing them to the risk of petty theft. One-of-its-kind personal locker to organize and secure your everyday valuables.

#### FITTINGS

- ① Vertico Mono Vertically Sliding System
- ② Lega Move Lifting Column System
- ③ ArciTech Drawer System

#### CMF

Silver, Snow White, Beige  
MDF,  
Matt, Bead Blasted



#hide #livingroominterior #hettichfurniturefitting





IDEA #8

# TRIGO

Home Office | Study Unit

The revolutionary moving storage makes your life easy and practical. The regular inundations on the surface helps you collate and keep your surroundings in order. With one hand sway gesture, you can make your screen animate and interact with countless possibilities of entertainment.

★  
**Technology Integrated: Interactive Screen**  
A combination of a traditional mirror with a high quality modern technology. People who look at themselves in it will not only see their own reflection but also a personalized marketing form like graphics, text or video.

#### FITTINGS

- ① SlideLine M Sliding System
- ② Comfort Spin Rotating Tray
- ③ Quadro Runner

#### CMF

White, Soft Maple, Beige, Misty Grey  
Rainbow Metal, Perforated Metal, MDF  
Matt



#interact #homeoffice #prior #hettichfurniturefitting





IDEA #9

# FLASH

Living Room | Entertainment Unit

This angular form, drives the major factor of showbiz. The roll up TV elegantly merges with the body, creating a harmony. The thick slatted shutters act as metallic blinds to hide what's on the inside.

## ★ Technology Integrated: Roll Up TV

A work of art fit for your luxury lifestyle, with a TV that appears when you need it and disappears when you don't. The display rolls out to three different heights — each with a unique purpose, all with a stylish look that complements your space.

### FITTINGS

- 1 Vertico Synchro Vertically Sliding System
- 2 Sensys Hinge
- 3 Eco Spot Magic Light

### CMF

Olive Green, Olive Yellow, White, Misty Grey  
MDF, Metal Slats  
Matt, Textured White



#enlight #livingroominterior #hettichfurniturefitting



IDEA #10

# AURA

Drawing Room | Showcase

Take a break amidst nature. Aura lets you relieve your stress, just by giving out the right fragrance. Compose and calm your senses by listening to nature and literally being in it. The sliding shutters add magic to your experience.

★  
Technology Integrated: Aromatic Diffuser  
Designed to fill the air with fragrance and moisture, a perfect tool for aromatic relaxation. Just add a few drops of your favourite essential oil with water in the tank and unwind.

## FITTINGS

- ① Quadro Runner
- ② SlideLine M Sliding System
- ③ Vertico Synchro Vertically Sliding System

## CMF

Pearl Black, White Oak  
MDF, Brass  
Matt, Antique Brass



#aroma #drawingroominterior #hettichfurniturefitting



# SLIDING & FOLDING DOOR SYSTEMS



**TopLine XL K2**

- Ease of assembly kit for wooden doors
- Silent system works perfectly from door weight of up to 100 kgs
- Built-in height adjustment



**TopLine L**

- Universal kit for wooden & aluminium framed door
- Multiple bottom options
- Built-in height adjustment



**SlideLine 56**

- User friendly in every day use
- Simple technology for easy assembly
- Optional silent system



**SlideLine M**

- Single-track sliding door system for overlay & inset door position
- For sliding doors weighing up to 30 kg
- Soft opening, soft closing and anti colliding function



**WingLine L**

- Purist and convenient: No distracting bottom profile
- Tool-less installation
- Minimal door protrusion for efficient space utilization



**Vertico Synchro**

- Door can run in an inset or overlay condition
- Synchronising mechanism of doors in vertical direction
- Fascinating interplay between open and closed surfaces





IDEA #11

# NESTER

Bed Room | Study Unit

Nester makes your work quick and efficient and houses almost everything in itself – from rolls, to magazines and also some memorable items. The shutters in itself acts as a storage compartment for your most read zines!

★ **Technology Integrated: Docking Station**  
With wireless docking, you can dock and undock your laptop without having to connect and disconnect a cable. That means, you can save time and move more freely to and from your work area, with your laptop in hand.

## FITTINGS

- 1 Vertico Synchro Vertically Sliding System
- 2 Actro 5D Runner
- 3 Sensys Hinge

## CMF

Sky Blue, Misty Grey, Douglas Fir  
MDF, Acrylic Sheet  
Super Matt

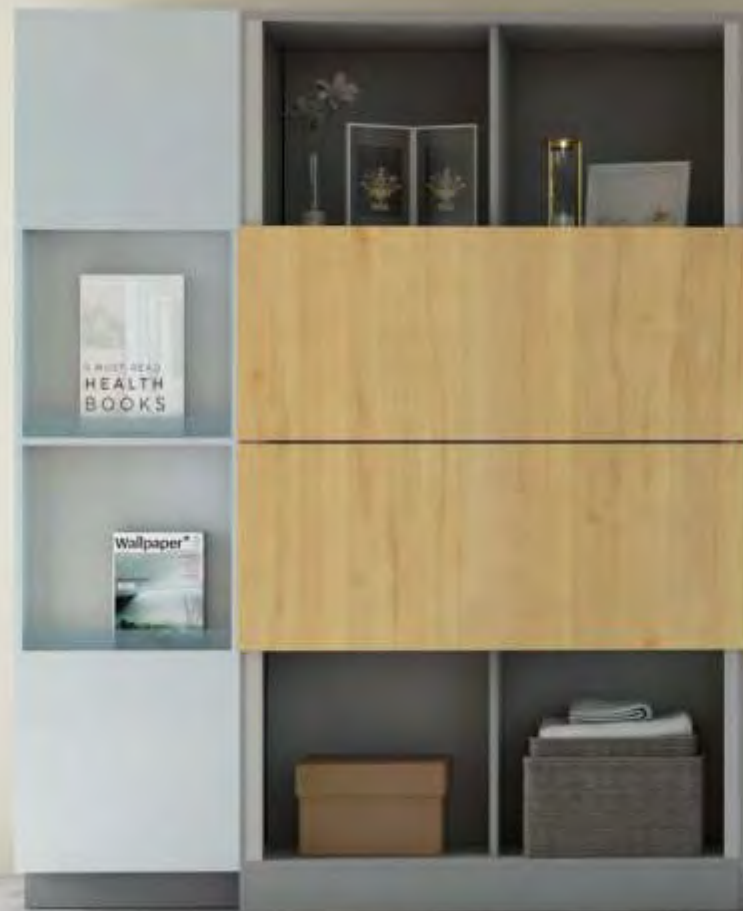

#gird #bedroominterior #hettichfurniturefitting





IDEA #12

# CASPIAN

Bed Room | Smart Study

Enjoy the breath-taking view with the perfect companion. In this age of modernization, smart boards have become a boom. The new age of working utilizes the bare minimum of material and gives out more than expected. The thought of having a storage in the fascia itself is a reflection of the next-gen thinking.

★  
**Technology Integrated: Vibe Smartboard**  
An all-in-one solution that combines an interactive digital whiteboard and smart software on a 4K Ultra HD display. Brainstorm and go crazy!

## FITTINGS

- ① AvanTech YOU Drawer System
- ② Obsidian Black Sensys Hinge
- ③ Cube PLUS Shelving System

## CMF

Soft Maple, Snow White  
MDF, Glass  
Matt



#vibe #bedroominterior #hettichfurniturefitting

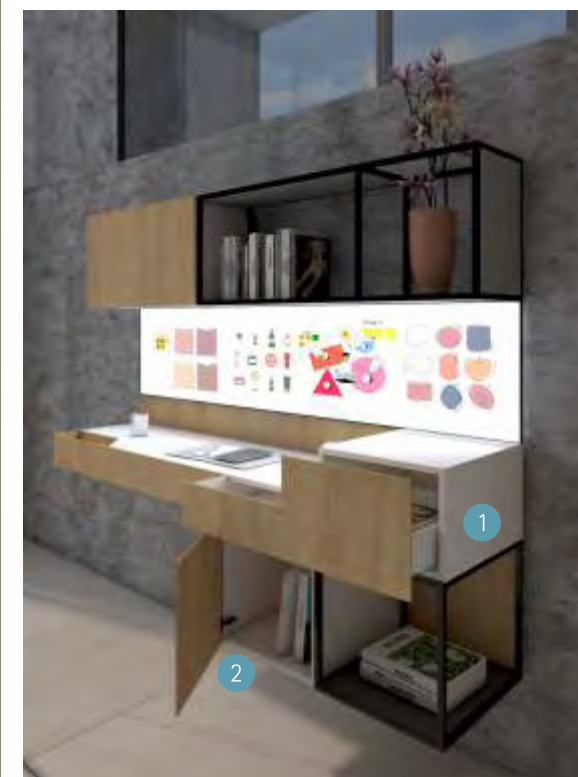



IDEA #13

# BLIXT

Living Room | Workstation

Blixt is the ultimate guide to help lead a healthy lifestyle. It engages major motor skills and keeps you on your toes, whenever necessary! It has been integrated with an air purifier which merges into the furniture and the surrounding. It gives a seamless look without attracting much attention.

★  
**Technology Integrated: Air Purifier**  
This is a new-concept furniture and home appliance which naturally fits in any space, combining the functions of furniture design and an air-cleaning humidifier.

#### FITTINGS

- ① Cube PLUS Shelving System
- ② Actiforce Height Adjustable Table
- ③ AvanTech YOU Drawer System

#### CMF

Metallic Snow White, Star White, Misty Grey  
MDF, Glass, Perforated MS Sheet  
Satin

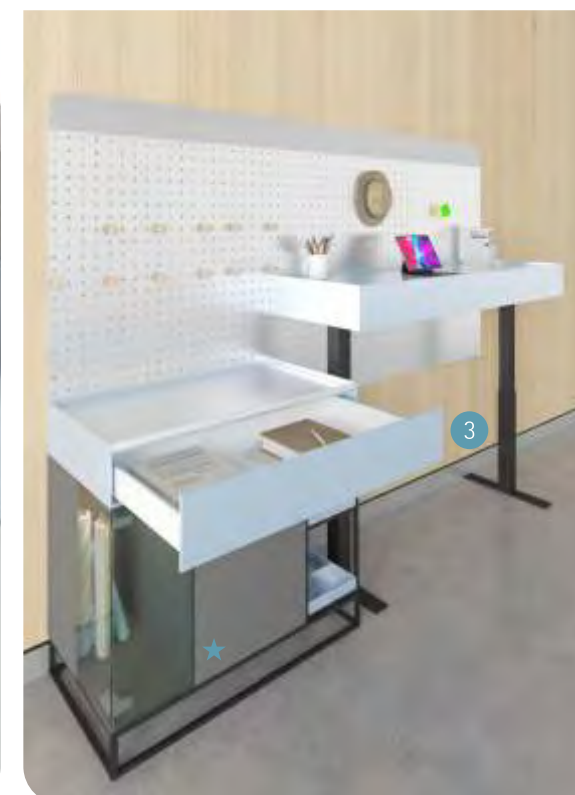
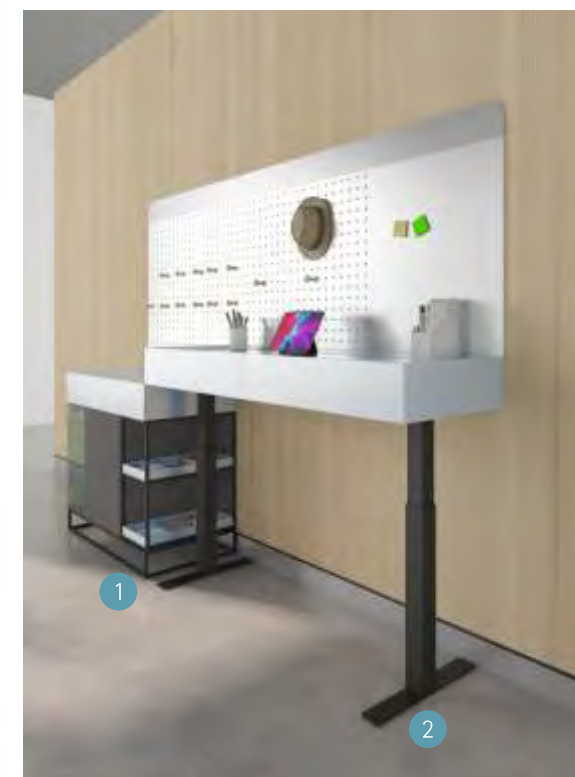

#pure #livingroominterior #hettichfurniturefitting



IDEA #14

# DROIT

Drawing Room | Coffee Table

This multi purpose coffee table makes everything look conspicuous. The tray formation has been inspired and derived from the golden triangle, which helps further in distinguishing each element in use. The inbuilt chiller is well within your reach simply by smoothly gliding the table top with ease.

★ **Technology Integrated: Drawer Chiller**  
Welcome to the new world of comfortology! A smart mini bar, which lets you regulate temperature according to your convenience. It carries advanced solid state electronic cooling technology.

## FITTINGS

- 1 AvanTech YOU Drawer System
- 2 SlideLine M Sliding System

## CMF

Mountain Brown, Soft Beige, Hickory  
MDF, MS Sheet  
Matt

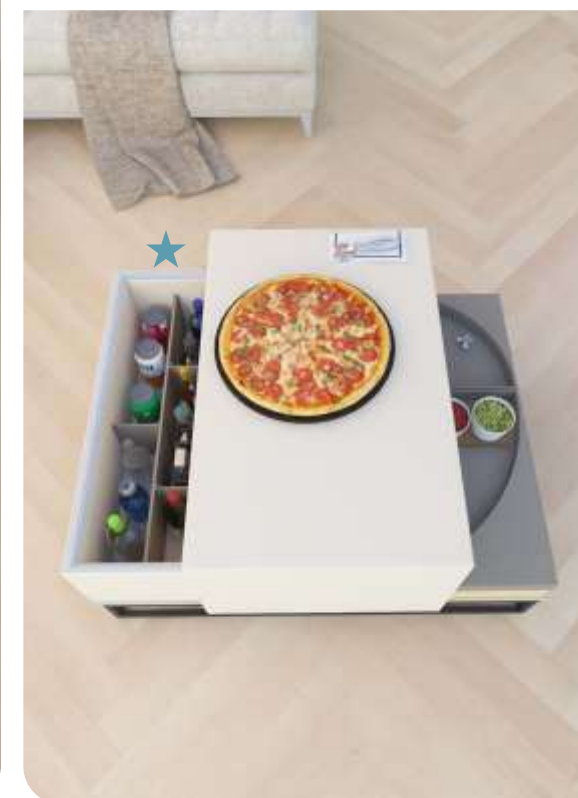

#gide #drawingroominterior #hettichfurniturefitting





A major shift towards exercise and fitness in the interiors has opened up ample opportunities for us to play with! This unit does the same. It engages you to stay healthy and fit during your online work hours at home. It houses space for your everyday essentials, which can be further accessed comfortably.

★  
**Technology Integrated: Smart Fitness Mirror**  
An interactive home mirror that delivers fully personalised & interactive sessions for body, mind and nutritional health. It offers personalised workout plan and monthly progress call with your personal trainer.

## FITTINGS

- 1 SlideLine M Sliding System
- 2 Obsidian Black Sensys Hinge
- 3 Versa Inside 80 Magic Light

## CMF

Misty Grey, Beige  
MDF, Mirror, Perforated Metal  
Super Matt

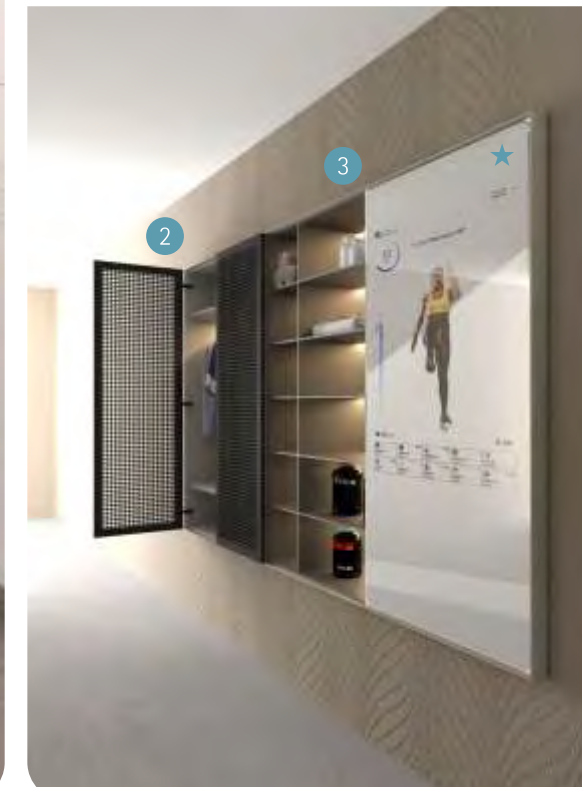
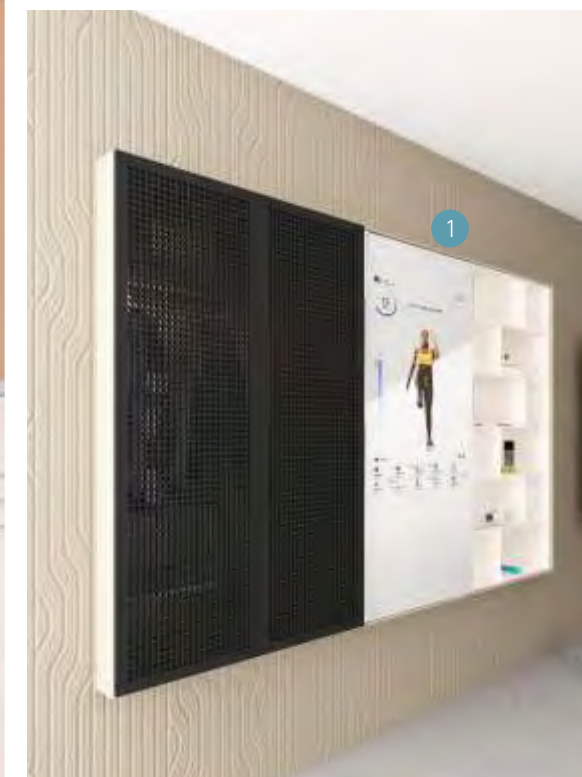
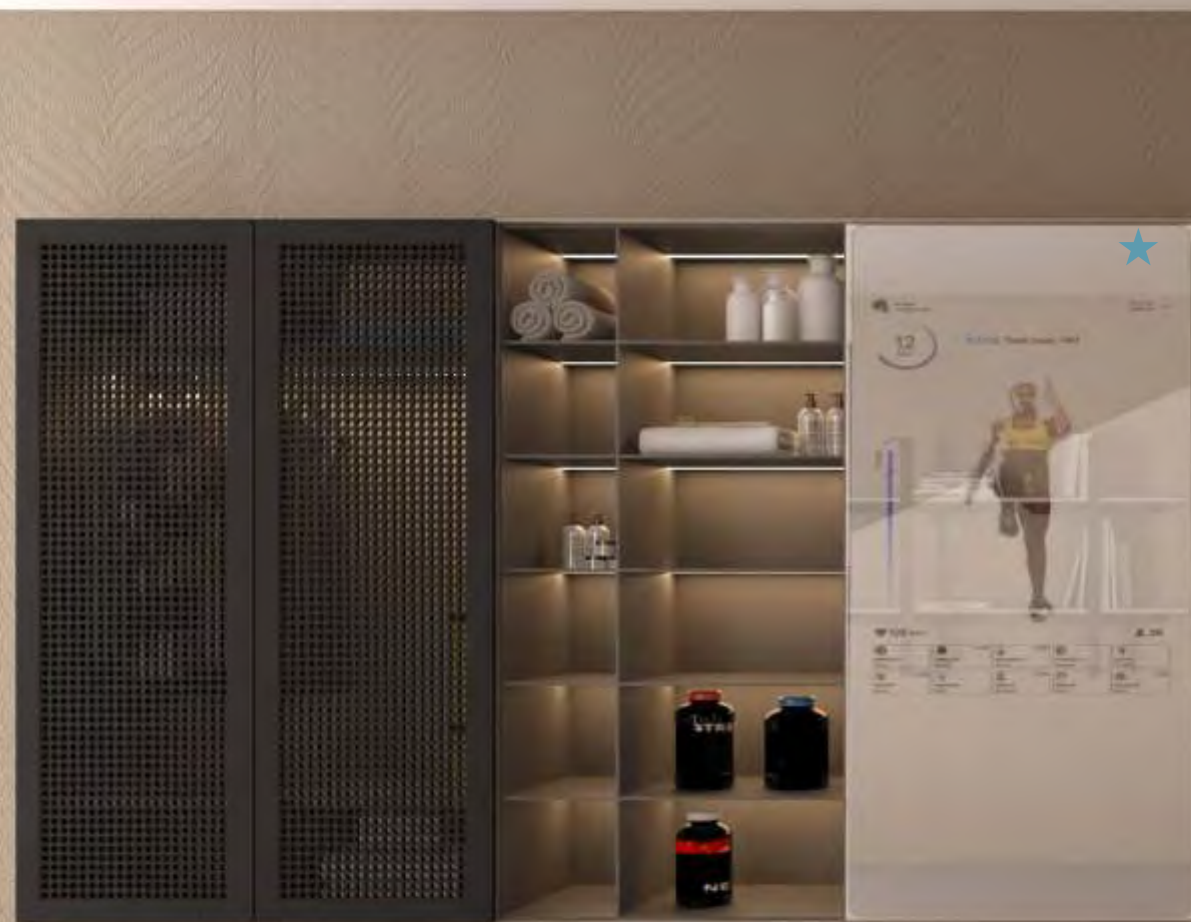

#eals #recreationalroominterior #hettichfurniturefitting





# ACCESSORIES



**Pencil Tray**

- Tray in high quality plastic
- Either 40 mm or 60 mm high
- Available in white, black and aluminium look



**ComfortSpin**

- Stored food and products can be reached easily and comfortably
- Turns 360° without any restrictions
- Easy to take out for cleaning



**Smar Tray**

- For writing accessories
- For concealed installation of drawer runners
- Tool-less slide on installation



**Cube PLUS**

- Create infinite design possibilities
- Rust free shelving system
- Ideal for light weight storage solution



**Franke**

- Ergonomic and comfortable seating
- Exclusive lying comfort based on a system
- Modular system for configuration flexibility



**Actiforce**

- Height-adjustable table frames
- Easy-to-install systems for home offices and professional offices
- Efficient storage space solutions





# STRIDER

Kitchen | Smart Kitchen

Strider lets you enjoy your cooking time. It not only helps you cook but stream many shows and also help you with your recipe. It houses a pantry unit with the most advanced technology furniture fittings. The internal drawer system gives you sufficient light through the glass inlay, making your meals the most enjoyable ones.

★ **Technology Integrated: GE Cooking Range**  
One of the biggest advantages of IoT - enabled kitchens is that it allows operators to remotely monitor ovens and other cooking equipment so that cooking efficiency is optimized and consistent product quality is maintained.

## FITTINGS

- ① AvanTech YOU Drawer System
- ② TopLine L Sliding System
- ③ Quadro Runner

## CMF

Silky Silver, Soft Pine  
MDF, Glass  
Super Matt, Brushed Metal

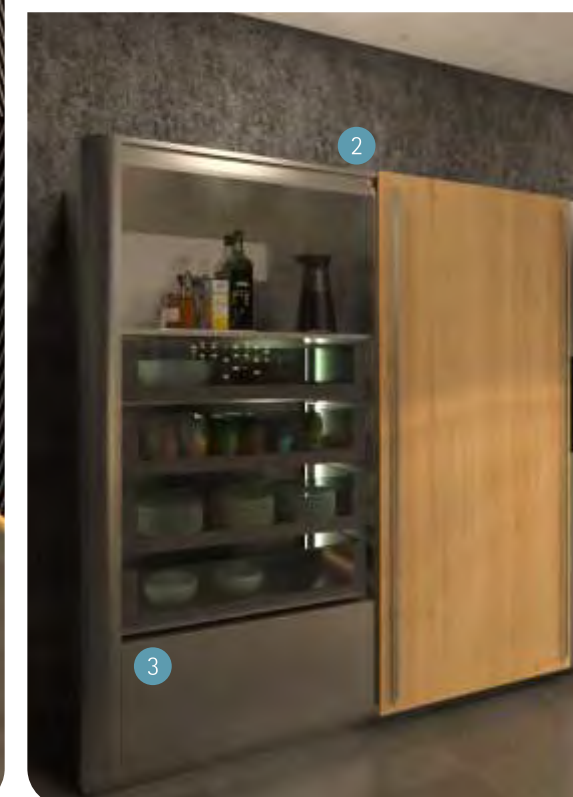
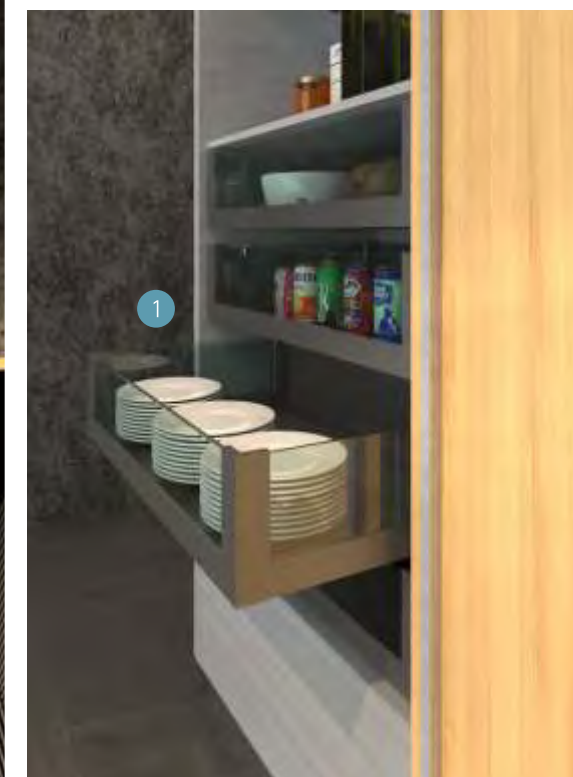



IDEA #17

# RIFT

Bedroom | Workstation

The idea behind the moving storage shows how versatile your surrounding is. The innate experience of storing not only enhances your workspace but also your work efficiency. The external shelf with integrated RFID makes you personalise your storage system at your convenience.

★  
**Technology Integrated: RFID Lock**  
Let the RFID Smart Lock handle your important possessions! You need not worry a bit now as it offers personalised key card and voice unlocking system.

#### FITTINGS

- ① Cube PLUS Shelving System
- ② AvanTech YOU Drawer System
- ③ WingLine L Sliding Folding System

#### CMF

Star White, Hickory  
MDF, Acrylic  
Super Matt, Brushed Metal



#cache #bedroominterior #hettichfurniturefitting



IDEA #18

# HYGIA

Bathroom | Vanity

Hygia makes sure you and your child have a safe and a salubrious experience. A simple hand gesture activates the mirror screen, allowing you to browse the latest trends and worldly updates. It also carries ample storage with smooth running and heavy load bearing drawer runners, making your experience pleasant.

★  
**Technology Integrated: Smart Mirror**  
Investing in a smart mirror is a great way to upgrade your bathroom. They typically come with a touchscreen display, integrated lighting, an anti-fog mechanism and can be voice controlled.

#### FITTINGS

- ① AvanTech YOU Drawer System
- ② Cube PLUS Shelving System
- ③ Actro Runner

#### CMF

Misty Grey, Honey Oak  
MDF, Felt Fabric  
Matt





IDEA #19

# FLUX

Utility Room | Storage Unit

Want wrinkle free clothes? Just a slide away! Flux carries a very sensible design element of portable tray system which helps segregate your dirty and clean laundry. Having a slider mirror also keeps you busy with admiring yourself. Besides, large drawers help you store big detergent bottles and other essential items.

★  
**Technology Integrated: Smart Laundry**  
Need quick wrinkle free clothes for use? Don't worry! We are on it. The Smart Laundry helps store shirts and trousers for quick ironing and crisp wear.

#### FITTINGS

- ① AvanTech YOU Drawer System
- ② SlideLine M Sliding System
- ③ Sensys Hinge

#### CMF

Misty Grey, Mint Green, Straw Balsam  
MDF, Mirror, MS Sheet  
Satin



#criso #utilityroominterior #hettichfurniturefitting



The sky is not the limit; its just the beginning! This ground breaking idea to have a live moving partition which adjusts and transforms according to your needs, is definitely a game changer. It can be kept and placed between any two open spaces which may need a clear distinction. Large and tall pullouts houses your entertainment essentials and a small cozy nook, where you can grab quick snacks and a book to read.

★ **Technology Integrated: Mini Chiller**  
A personal cooling solution with no compressor and no refrigerant. It is powered by the futuristic solid state electronic cooling technology which is 100% environment friendly, efficient and silent.

**FITTINGS**

- ① TopLine XL K2 Sliding System with Castors
- ② Actro 5D Runner
- ③ AvanTech YOU Drawer System

**CMF**

Grey, Blue  
MDF, Mirror, MS Sheet  
Satin



#enchanted #drawingroom interior #hettichfurniturefitting



Smart  
Furniture  
Ideas  
Integrated  
with  
Technology



Drawings of  
Smart Furniture Ideas

**#1 VEIL**  
1800 x 1200 x 350

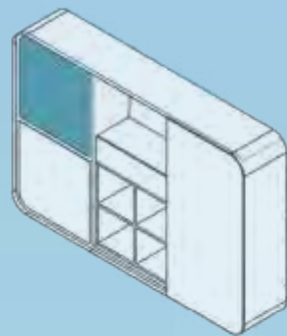

**#2 PIXEL**  
1800 x 1200 x 300

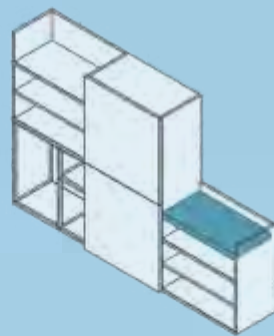

**#3 SIGMA**  
1800 x 1700 x 500

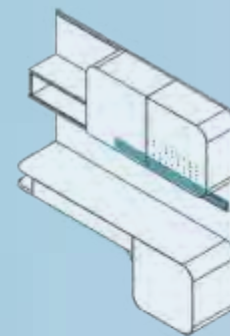

**#4 ARMIS**  
2500 x 2100 x 550

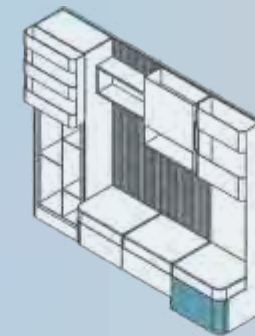

**#5 TETRIS**  
1050 x 1700 x 350



**#6 VIRTUA**  
2250 x 1950 x 600

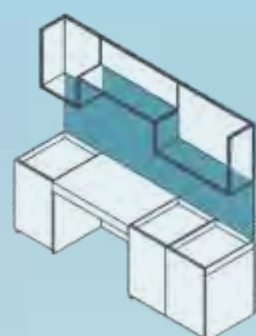

**#7 LUKE**  
2450 x 1450 x 450

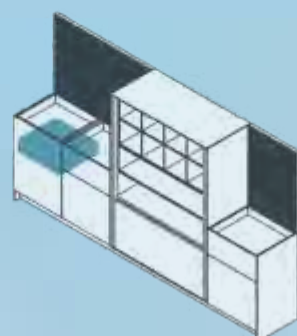

**#8 TRIGO**  
2800 x 1550 x 450

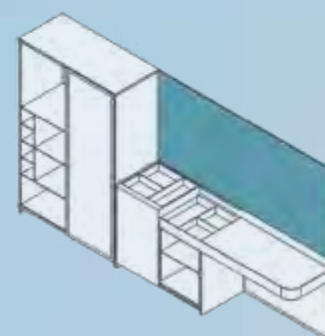

**#9 FLASH**  
2300 x 1900 x 500

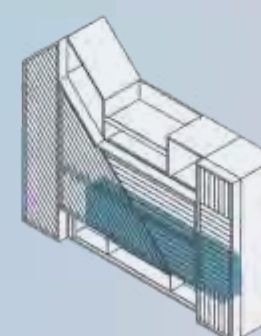

**#10 AURA**  
2400 x 2500 x 600

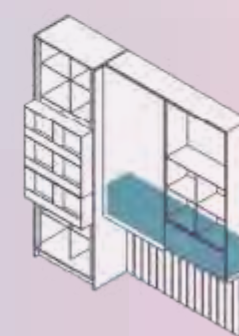

**#11 NESTER**  
1800 x 2100 x 600

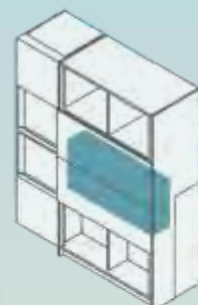

**#12 CASPIAN**  
2100 x 1650 x 500

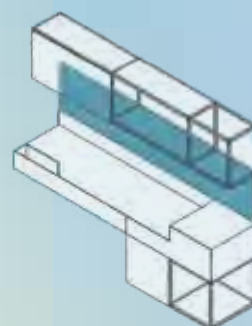

**#13 BLIXT**  
2900 x 2200 x 600

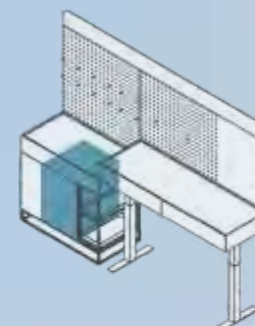

**#14 DROIT**  
2000 x 550 x 900

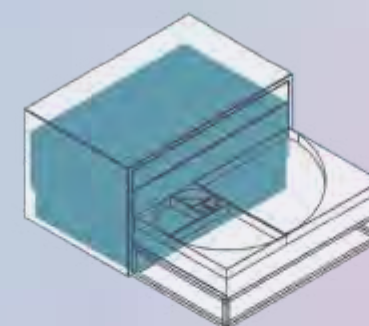

**#15 ADRIA**  
3000 x 1800 x 550

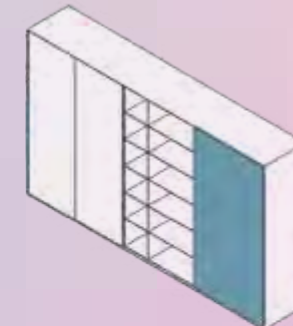

**#16 STRIDER**  
4500 x 2100 x 600

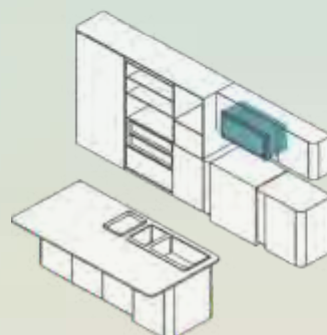

**#17 RIFT**  
1600 x 1800 x 500

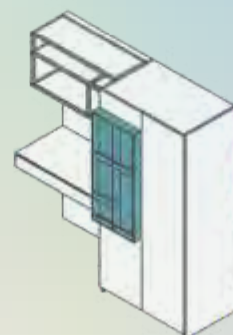

**#18 HYGIA**  
1400 x 1200 x 600

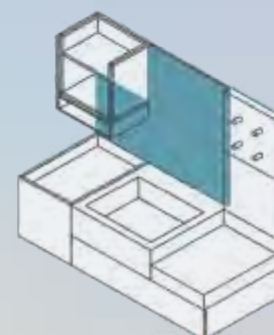

**#19 FLUX**  
1500 x 2100 x 600

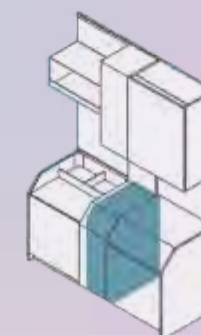

**#20 SKAI**  
4000 x 3000 x 550

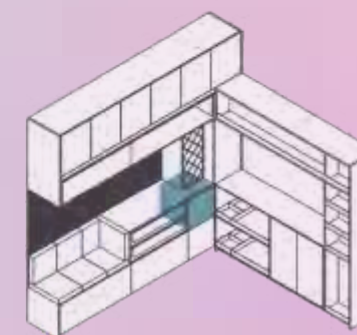



# NOTE

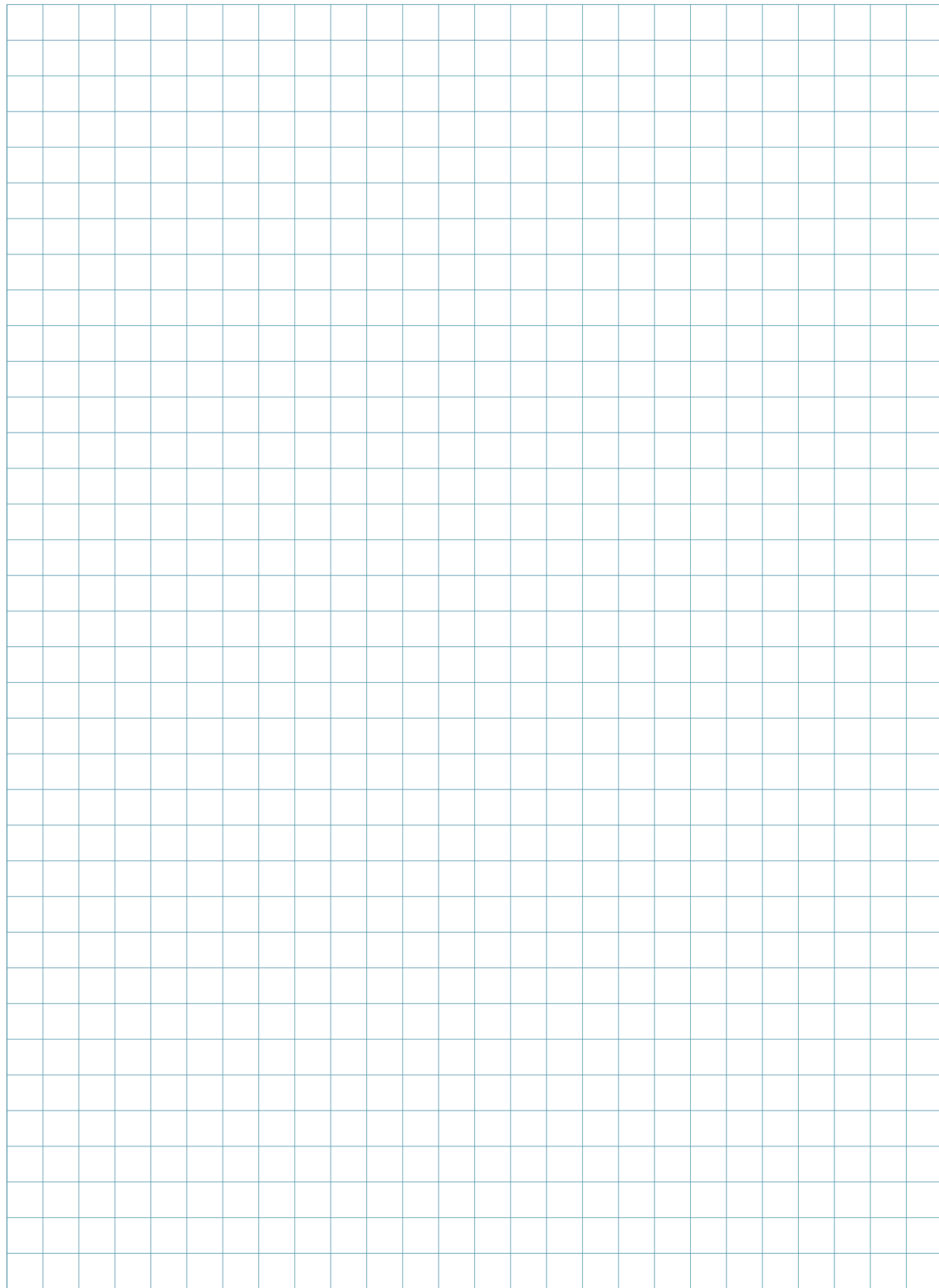
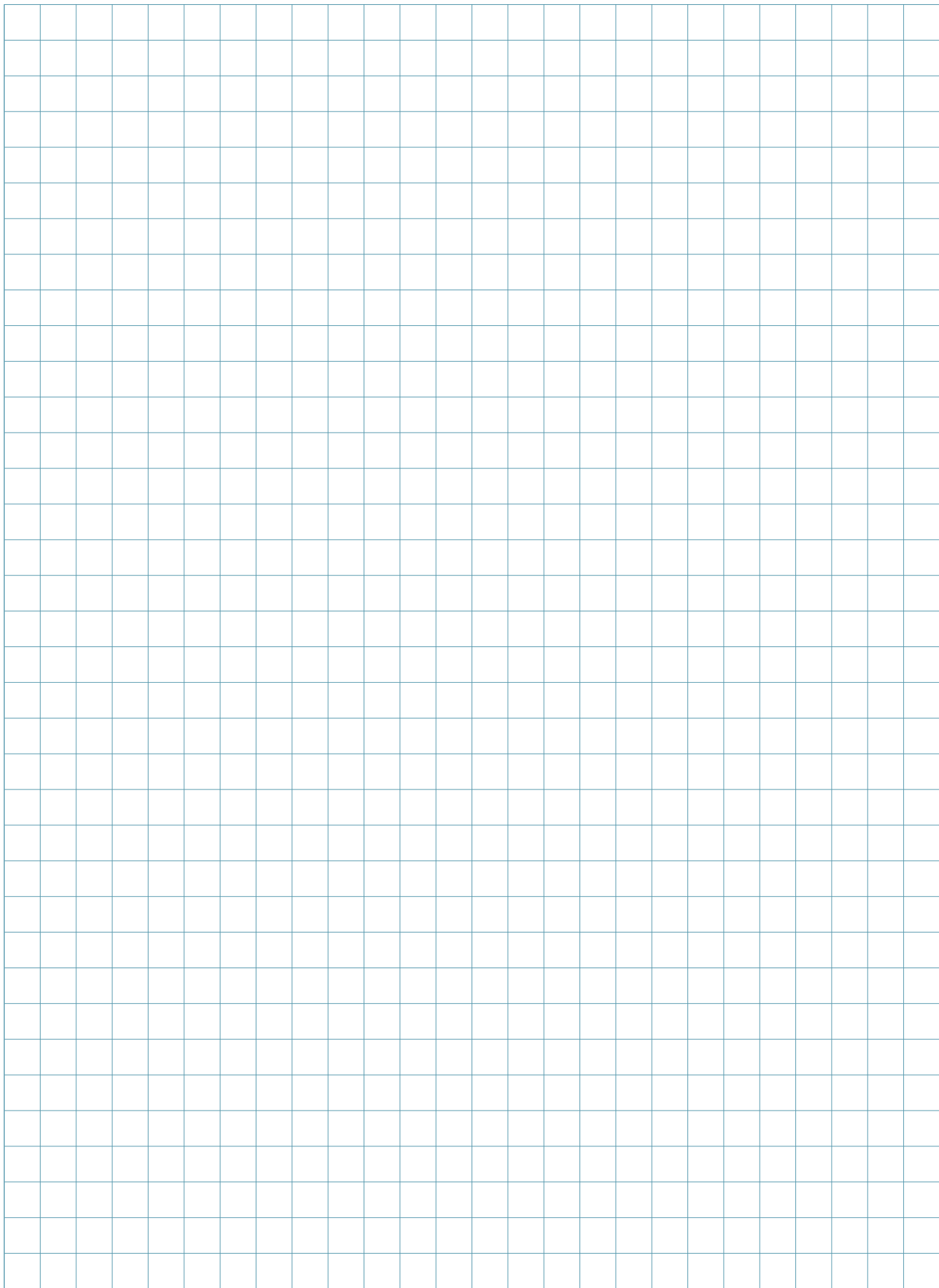



# PAN INDIA HETTICH SERVICES & NETWORK

## Offices:

**Registered & Head Office:**  
Hettich India Private Limited  
302, Durolite House,  
Opp. SAB TV, New Link Road,  
Andheri (West), Mumbai - 400 053  
Phone: +91 22 2674 3289/3356/4089

**Delhi Office:**  
Hettich India Private Limited  
A-26/4, 1st floor,  
Mohan Co-operative Industrial Estate,  
New Delhi - 110 044  
Phone: +91 11 4889 4000, 4889 4005

## Production Sites:

**Vadodara:**  
Hettich India Private Limited  
Plot No. 304, Dhanora,  
Nandesari Road,  
Near ECPL,  
Village - Dhanora - 391 346  
Dist. - Vadodara, Gujarat

**Indore:**  
Hettich India Private Limited  
Plot No. 1, Sector - 5,  
Mhow - Neemuch Road,  
Opp Lupin Ltd, Pithampur Industrial,  
Pithampur - 454 774  
Madhya Pradesh

## Training Centre:

Hettich Poddar Wood Work Institute  
Plot No.2, 1st Floor, DLF Industrial Estate-1  
Near NHPC Metro Station,  
Faridabad - Haryana  
Ph: +91 129 4203888  
Email: [info@hpwwi.com](mailto:info@hpwwi.com)

**Enquiry & Customer Services**  
Toll Free : 1800 209 2096 (office hours)  
Email: [sales\\_enquiry@in.hettich.com](mailto:sales_enquiry@in.hettich.com)  
[customer\\_services@in.hettich.com](mailto:customer_services@in.hettich.com)  
[www.hettich.com](http://www.hettich.com)

## Application Centres:

**Bangalore:**  
Adventz Center, Ground Floor 28,  
Cubbon Road, Shivaji Nagar,  
Bangalore - 560 001  
Ph. No. : +91 80 4530 0400,  
+91 80 4530 0401

**Mumbai:**  
202/302, Durolite House,  
Opp. SAB TV,  
New Link Road, Andheri ( West),  
Mumbai - 400 053  
Ph.No. : +91 22 2639 9707

**New Delhi:**  
61, Panchkuian Road,  
New Delhi - 110 001  
Ph. No. : +91 11 2358 0713,  
+91 11 2358 4603

**Chennai:**  
"Heavitree", Ground Floor,  
47, Spur Tank Road,  
Chetpet, Chennai - 600 031  
Ph. No. : +91 44 4263 7227

**Ahmedabad:**  
1st Floor, Unit No. 102,  
Safal Pegasus, Anand Nagar,  
Ahmedabad - 380 015,  
Ph. No. : +91 79 4032 2824

**Gurugram:**  
Global Business Park, Tower-A, 5th Floor,  
Mehrauli-Gurgaon Road, Sikandarpur  
Sector 26, Gurugram, Haryana - 122 002  
Ph. No. : +91 0124 4221670

**Hyderabad:**  
" Sai Krishna "  
797 - A, 2nd Floor,  
Road No. 36, Jubilee Hills,  
Hyderabad - 500 034  
Ph. No. : +91 40 2355 8994

**Indore:**  
Office No.106 and 107-A,  
"Brilliant Titanium",  
Plot No.9, Scheme No.78, Part-II,  
Indore - 452 010,  
Ph. No. : +91 96 9168 4480

**Chandigarh:**  
2nd Floor,  
Aspire Tower, Plot no. 55,  
Industrial & Business park, Phase 1,  
Chandigarh - 160 002  
Ph. No. : +91 172 5012 347

**Kochi:**  
41/2062D, 2nd Floor  
Palarivattom signal  
junction, NH 47 By-pass,  
Kochi - 682 028  
Ph. No. : +91 48 4402 8242

**Pune:**  
Server Space,  
Survey No. 127/1A  
Plot no.8, Off. ITI Road, Anudh,  
Pune - 411 007  
Ph. No. : +91 72 0847 6557

**Kolkata:**  
2nd Floor, Unit Number 2A,  
Tirumala 22,  
East Topsia Road,  
Kolkata - 700 046  
Ph. No. : +91 98 3101 2054



Visit us  
[www.hettich.com](http://www.hettich.com)

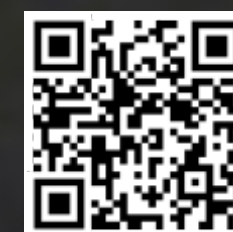

Shop now  
[www.hettichindiaonline.com](http://www.hettichindiaonline.com)





**SMART**  
FURNITURE IDEA BOOK

Smart Furniture | IdeaBook | HIN | JUNE 2022

Follow Hettich India

